

GL GAMMA EC

Centrifugal Roof Mounted Exhaust Fans

ELTA



GL GAMMA EC



Description

The GL Gamma EC of centrifugal roof mounted exhaust fans incorporate the latest state of the art, energy saving EC motor technology.

They feature integrated infinitely variable speed control and eliminate the need for external VSDs, current overloads and motor phase protection.

The compact and low profile GL Gamma EC is a simple “plug and play” system which means installers do not need to have specialised control programming knowledge.

Matching sensors can easily be connected to monitor the ambient conditions in a space and provide real time feedback to the fan. The fan’s on-board microprocessor can adjust the speed and therefore modulate the ventilation rate to match the specific requirements of the area.

They are suited to ducted vertical exhaust applications, include a removable windband that provides easy access for cleaning and maintenance, and are available in 315, 355, 450, 560 and 630mm fan sizes.

Typical Applications

Can exhaust clean air and a range of toxic and noxious gases from a wide range of commercial and industrial applications. Ideal for applications requiring an all metal construction and where the amount of air required varies according to demand.

Features

- EC motor features reverse polarity protection, locked rotor protection and soft start.
- No additional protection such as contactors are required.
- Can be pre-configured to suit specific sensors and applications, and are supplied standard with 0-10V control input.
- A full range of sensors are available including differential pressure, humidity, temperature, air velocity and pollutant.
- Can be run as an independent ventilation source or integrated into most building management systems.
- Robust, galvanised steel housing and cowl.
- Quick release toggle clamps provide easy access for cleaning and maintenance.
- Can be mounted at angles up to 30°.

Construction

Cowls are of galvanised steel construction. Impellers are backward-curved centrifugal design and are of high performance composite material. Bird-mesh guards are an optional extra. Powder-coating is an optional extra.

Ancillary Equipment

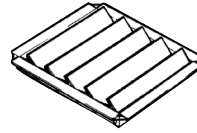

CBD - Backdraft shutter



DCV-CU - Premium Module on-board control pack

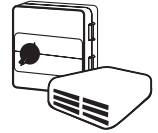

Controllers & Sensors

Additional Information

Backdraft shutters are an optional extra.

The pressure loss across the shutter has to be added to the system pressure before making selections.

All GL Gamma EC models can be pre-configured to suit specific sensors and specific applications. Please advise Elta of these parameters at the time of order.

EC motors should be directly connected to their appropriate AC supply. EC motors should not be regularly power cycled.

Motor

Type - electronic commutated (EC) motor.

Electricity supply - 200-277V single-phase, 50/60Hz for 315 to 450mm sizes.
- 380-480V three-phase, 50/60Hz for 560 and 630mm sizes.

Ball Bearing - sealed for life.

Integrated EC-Controller providing infinite speed control.

Maximum ambient temperature is 60°C
CDEC56VGL cannot exceed 16.8r/s at 60°C

Internal Thermal Protection

Integral thermal overload protection is supplied as standard.

Testing

Airflow tests to ISO 5801:2007.
Noise tests to ISO 3744:2010.

Suggested Specifications

The roof ventilators shall be of the GL Gamma EC vertical discharge type as designed and manufactured by Elta and be of the model numbers shown on the schedule/drawings. Impellers shall be made from high performance composite material. They shall be of backward-curved centrifugal design and driven by EC external rotor motors with integrated EC Controller and integral thermal overload protection. They shall be pre-configured to suit the selected sensors and the required applications.

The cowl shall be of the vertical discharge design and manufactured from galvanised steel. Steel components shall be corrosion protected.

The windband shall incorporate quick-release toggle clamps to provide easy access for cleaning and maintenance.

All models shall be fully tested as a complete assembled unit to ISO5801:2007 for airflow and ISO 3744:2010 for noise.

How To Order

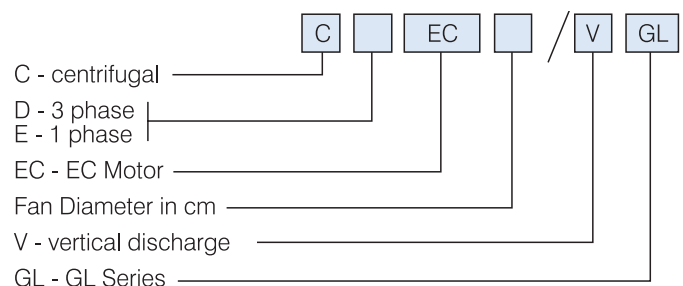

Technical Data

Model CDEC...VGL CEEC...VGL	Percentage of full speed (%)	*Max. Fan Speed r/s	Airflow @ 0Pa m ³ /s	Avg. dB(A) @ 3m	CEEC.. 1ph kW	Amps	CDEC.. 3ph kW	Amps
31	100	34	0.58	60	0.27	1.60	-	-
	80	27	0.46	55	0.15	0.85	-	-
	60	20	0.26	48	0.07	0.43	-	-
	40	13	0.23	38	0.03	0.21	-	-
	20	7	0.11	21	0.01	0.13	-	-
35	100	27	0.87	58	0.25	1.60	-	-
	80	21	0.69	57	0.13	0.85	-	-
	60	16	0.52	50	0.06	0.43	-	-
	40	11	0.34	41	0.03	0.20	-	-
	20	5	0.17	24	0.01	0.12	-	-
45	100	24	1.50	60	0.55	2.90	-	-
	80	19	1.20	54	0.29	1.70	-	-
	60	14	0.89	47	0.13	0.78	-	-
	40	10	0.59	37	0.05	0.54	-	-
	20	5	0.30	20	0.02	0.34	-	-
56	100	21	2.63	64	-	-	1.14	2.40
	80	16	2.10	58	-	-	0.59	1.30
	60	12	1.56	51	-	-	0.27	0.70
	40	8	1.04	41	-	-	0.09	0.35
	20	4	0.52	25	-	-	0.02	0.19
63	100	21	3.87	66	-	-	1.95	4.00
	80	16	3.09	60	-	-	0.99	2.10
	60	12	2.31	52	-	-	0.44	0.97
	40	8	1.54	42	-	-	0.14	0.50
	20	4	0.77	26	-	-	0.03	0.23

* The fan will maintain the set speed whether run on 50 or 60Hz supply.

† The CDEC56VGL model is rated at 40°C for all speeds. This model cannot exceed 16.8 r/s at 60°C ambient.

Dimensions

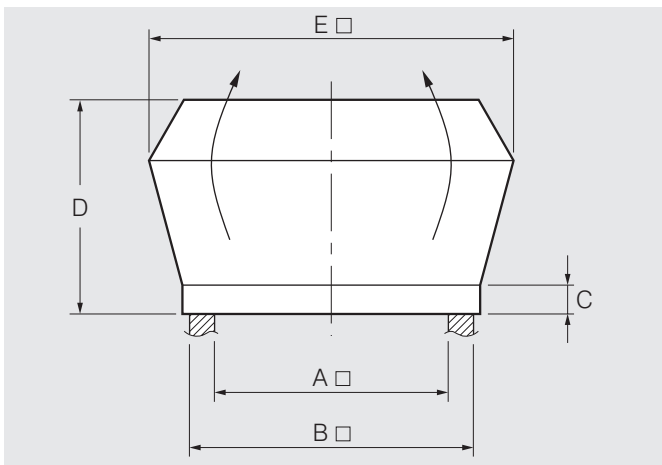

Model CDEC...VGL CEEC...VGL	Dimensions, mm					Approx. weight kg.	Approx volume m ³
	A	B	C	D	E		
31	310	410	50	310	520	20	0.10
35	400	500	50	420	670	23	0.22
45	620	720	50	525	900	45	0.50
56	620	720	50	525	900	49	0.50
63	710	810	50	665	1160	74	1.03

Backdraft Damper Losses

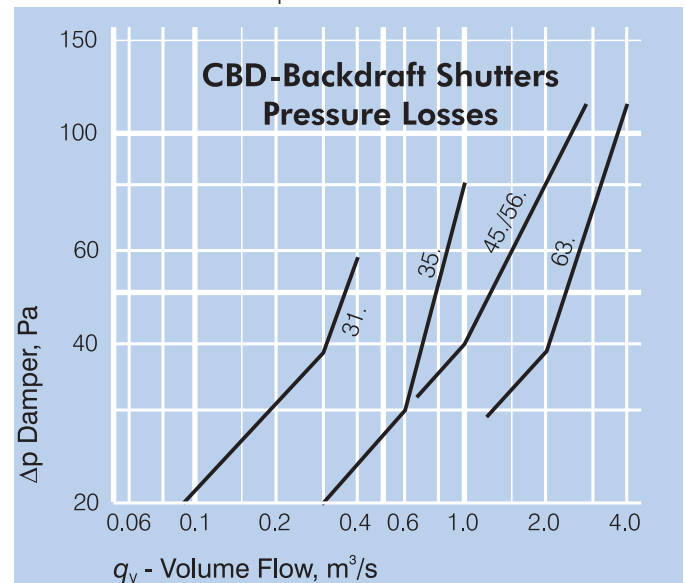

Additional Information:

If dampers are fitted, the pressure loss through them must be added to the system resistance before selecting the fan.

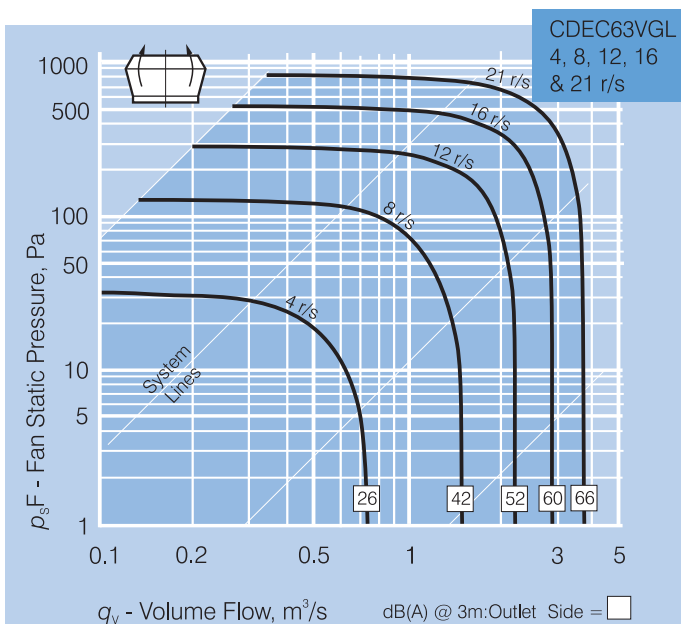
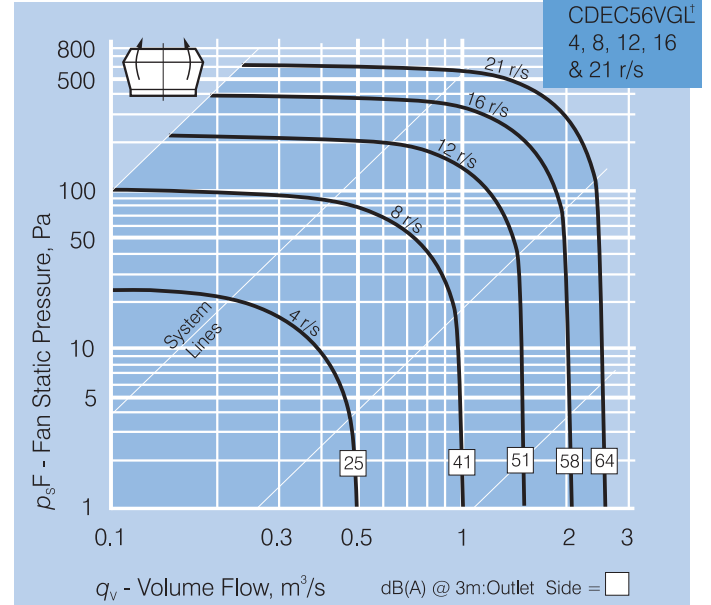
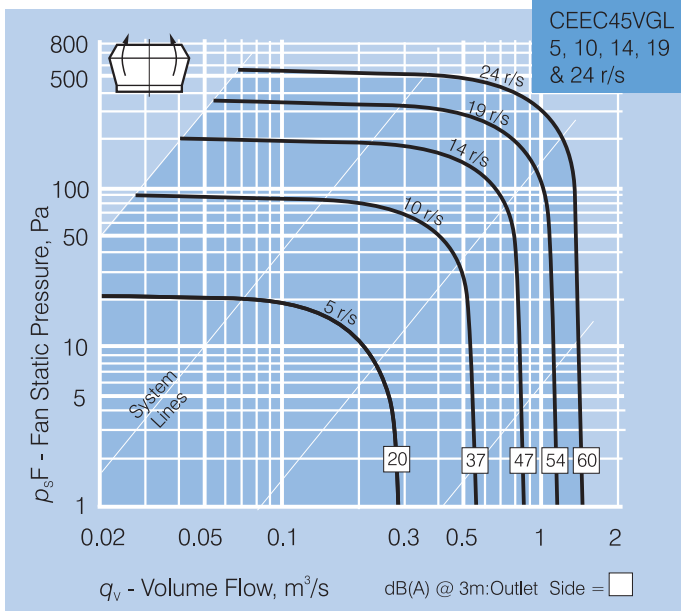
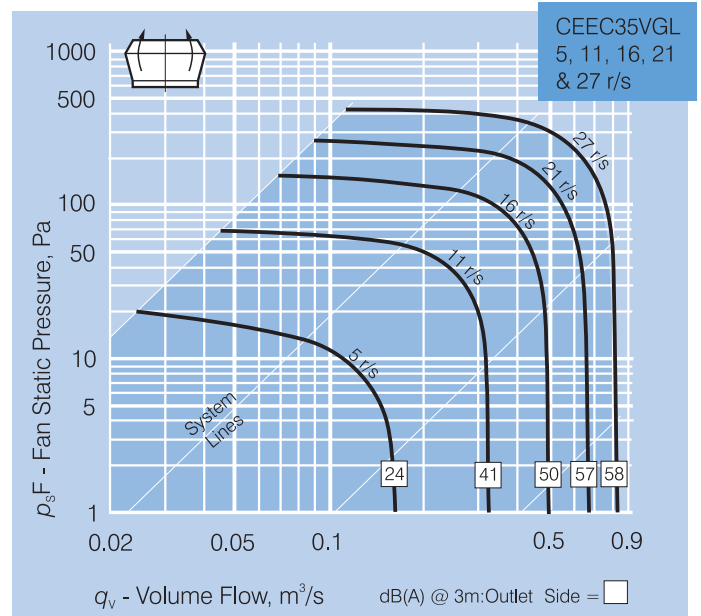
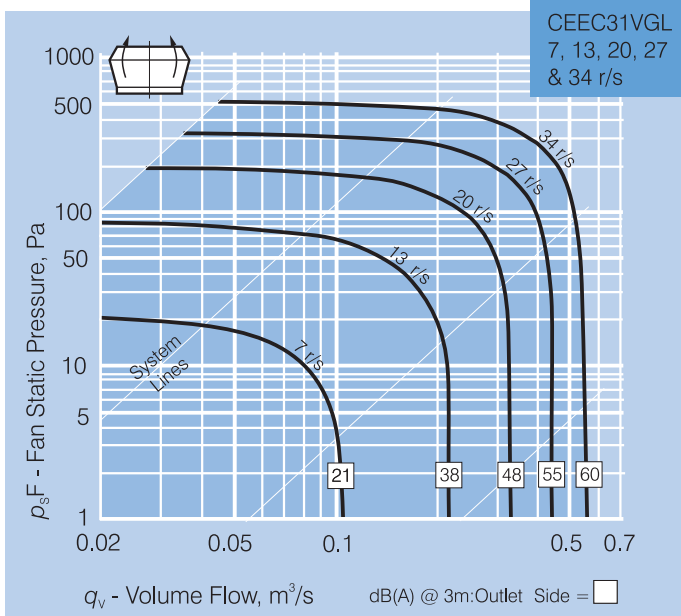

† The CDEC56VGL model is rated at 40°C for all speeds. This model cannot exceed 16.8 r/s at 60°C ambient.



Elta Asia Sdn Bhd

Tel **+603 7846 0340**

Email **info@elta.asia**

elta.asia

GLGEC-05-2026 Issue A



FS 676456

A MEMBER OF  ELTA GROUP