

# TURBULATOR HTS

Recirculation Fan

---

**ELTA**



# TURBULATOR HTS

## Product Overview

**The Turbulator range of recirculation fans provide constant airflow and are suitable for all year round ventilation.**

**Its strong construction was designed specifically for long service life in poultry, dairy and horticulture, removing condensation and providing evenness of temperature and humidity.**

The Elta Turbulator is a tough circulation fan designed for use in agriculture and horticulture from conception, featuring a profiled 1.2mm Aluzinc tube shell and internals that will not corrode in the harshest of farm environments.

The internal air rectifier straightens and smooths the air exiting the unit for an exceptional throw perfect for use on farm. From drying the bedding in multi-tiered poultry housing, creating uniform greenhouse atmospheres or spot cooling and fly control for your cattle while in holding areas.

The 6-bladed, balanced, Elta impeller has endured thousands of hours of stress testing in our lab and on farm, proven to move high volumes of air with low vibration.

- Available in 800 & 900mm models
- Fits standard ventilation chimneys from any manufacturer
- Complete unit and spares available next day from stock for minimum downtime and cost
- 3 year warranty
- Designed and built for agriculture in Britain. Deployed extensively on farm for real-world usage testing



# TURBULATOR HTS

## Performance, SFP & Electrical Data

Single Phase 220V to 240V / 50Hz or 60Hz

Model Number	Diameter (mm)	Speed (r/min)	Airflow (m³/s)	Throw (metres)	dBA @ 3m	Power (kW)	FLC (Amps)
HTS450	450	1360	1.31	23.4	64	0.545	2.31
HTS500	500	945	1.21	19.7	57	0.280	1.33
HTS630	630	945	2.34	22.5	64	0.721	3.15

## Dimensional Data

Model Number	A	B	C	D	Weight (kg)
HTS450	460	440	75	115	20
HTS500	510	440	70	115	19
HTS630	660	630	70	115	30

Dimensions are in mm.

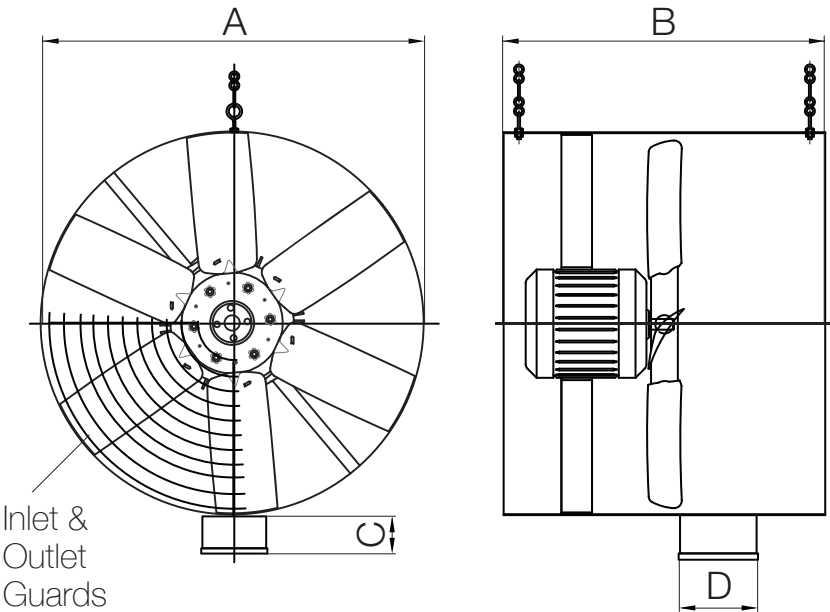

# TURBULATOR HTS

## Accessories

Model Number	Inverter Controller	Mechanical Thermostat HS1	Electronic Thermostat HP11W
HTS450	007828	003306	002371
HTS500	007827	003306	002371
HTS630	007828	003306	002371

Alu-Zinc casing as standard. Stainless steel upon request. Throw termination @0.5m/s. The overall A-weighted sound pressure level is at a distance of 3m with spherical free-field propagation. It is expressed in dB re-20µPa and is presented for comparative purposes only.

Tel **+44 (0)1725 511422**  
Email **agriculture@eltauk.com**  
**eltauk.com/agriculture**

ISSUE A. SEP 2025.