



TURBULATOR HTS

Installation & Maintenance

TURBULATOR HTS

Installation Instructions

Installation and Maintenance Instructions.

THESE INSTRUCTIONS MUST BE READ FULLY BEFORE COMMENCING INSTALLATION.

Owner / installer: The life of this apparatus and its efficiency will be increased if its use and maintenance is carried out in accordance with these instructions and current statutory requirements. The installation and initial adjustments should be carried out by a qualified and competent technician, ensuring the correct PPE is used at all times. Elta should be consulted before substituting or fitting parts from another manufacturer. It is the responsibility of the installer to verify that the installation is in accordance with all current statutory requirements and the owner is given the current User's Manual.

Any modifications to the fan or its installation, even the smallest modification, change or elimination of security components or pieces that influence the efficiency or loss of ventilation, will result in the CE Certification and Elta's warranty being cancelled.

Please note the following indicators used within this document:

WARNING: Hazards associated with electric current and high voltages.

IMPORTANT: Important information.

Elta's policy is one of continual improvement and the right to change a specification at any time without notice is reserved. Whilst every care has been taken to ensure that the contents of this document are correct at time of publication, Elta shall be under no liability whatsoever in respect of such contents.

Elta cannot guarantee the operation of any equipment unless all documented instructions are complied with, without variation.

1. General

- 1.1 It is important these Installation and Maintenance Instructions are fully adhered to.
- 1.2 Full details of the unit supplied are shown on the product nameplate. If in doubt about any detail contact Elta or its agents for clarification.
- 1.3 All electrical installation must be carried out by suitably qualified and competent personnel in accordance with all current statutory requirements.
- 1.4 Any declarations made by Elta about product installation and safety, are dependent on the fan equipment being used within installations which themselves meet the requirements of the relevant Standards and Directives of your region.
- 1.5 The fan is designed for use in an ambient temperature of up to 50°C and up to 95% relative humidity. The fan is not suitable for corrosive or explosive atmospheres.
- 1.6 The installer should provide easy access to the fan to facilitate future maintenance.
- 1.7 The installer should ensure the fan is adequately supported.
- 1.8 This product is not intended for use by young children or infirm persons unless they have been adequately supervised by a responsible person to ensure that they can use the product safely. Young children should be supervised to ensure that they do not play with the appliance.

WARNING: The fan must be isolated from the power supply during installation and maintenance. The fan must be earthed in accordance with the local regulations.

TURBULATOR HTS

Installation Instructions

2. Installation

- 2.1 Upon receipt, the fan equipment should be visually inspected to check for any damage. Ensure that the impeller is free to rotate.
- 2.2 If there are any queries concerning the fan equipment, Elta should be contacted prior to the installation.
- 2.3 The fan must be securely mounted in the desired position to suit the application. The fan can be mounted at any angle using the hanging chains supplied.
- 2.4 Check the details on the motor rating plate to ensure that the correct power supply (voltage, frequency and phase) is available. An incorrect power supply will lead to permanent damage to the fan motor.
- 2.5 The unit is supplied with a flying lead and standard UK 13 A fused 3-pin plug to BS 1363. Ensure that all earth connections are made.
- 2.6 Means for electrical disconnection must be incorporated in the wiring installation in accordance with the relevant wiring and electrical regulations.
- 2.7 If the fan is being used through a speed regulation device, refer to the relevant control device instructions.

3. Start-up

- 3.1 At initial start-up, check that impeller rotation and airflow direction is correct.

4. Fan Maintenance

- 4.1 Inspection of the fan at least once every 12 months is recommended to ensure that the motor, fan blades, and supporting guards, are clean. Any build up of dust and deposits on the blades or guards should be removed using a non-abrasive cleaner.
- 4.2 All fastenings should be checked for tightness. In addition, all rotating items should be checked.
- 4.3 Bearings are of the 'sealed for life' type and will not need a detailed inspection.

WARNING: Only a suitably qualified and competent person may carry out maintenance after the electrical supply has been isolated. Particular care must be taken when automatic switching controls are used.

5. Wiring

- 5.1 Check that the fan unit supplied is suitable for the supply voltage and type of fan being replaced.
- 5.2 Remove the terminal plate on the motor which will provide access to the terminal connections. A suitably qualified and competent person should carry out the electrical installation in accordance with the current applicable regulations, in particular BS 7671:2018+A2:2022, Regulations 552.1.2 and 552.1.3. Particular attention should be paid to the connections of the capacitor.

TURBULATOR HTS

Wiring Diagrams

5.3 Motors with flying leads with external terminal box
Single Phase

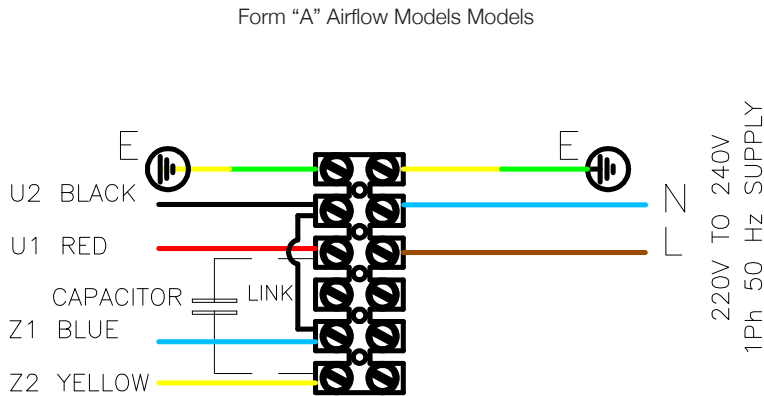

Anti—clockwise rotation (looking in the airflow direction)
To reverse the motor rotation interchange yellow & blue. (Wires do not have markings)

Three Phase
STAR (415V / 3Ph / 50Hz)

DELTA (230V / 3Ph / 50Hz)

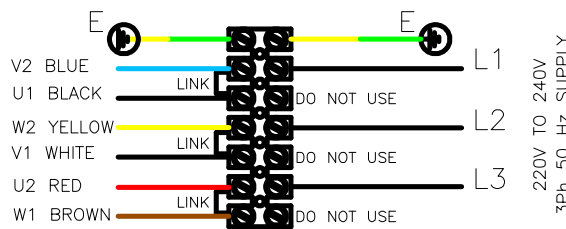
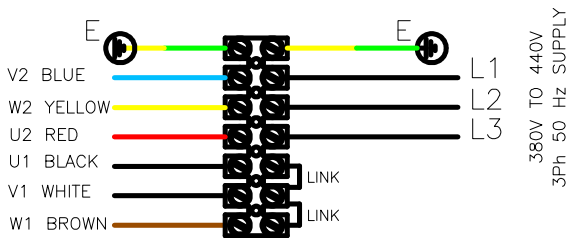

To reverse the motor rotation interchange any 2 supply phases (wires do not have markings)

TURBULATOR HTS

Installation Instructions

6. Dimensions

Model Number	A	B	C	D	Weight (kg)
HTS450	460	440	75	115	20
HTS500	510	440	70	115	19
HTS630	660	630	70	115	30

Dimensions are in mm.

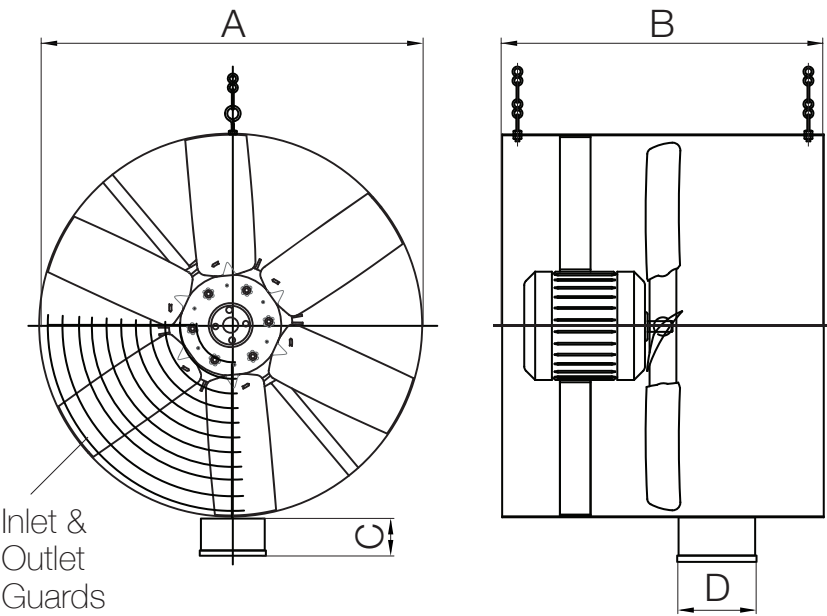

TURBULATOR HTS

Notes

[illegible]

TURBULATOR HTS

Notes

[illegible]

**Guarantee**

Elta or its agents will, within a period of 1 year from the date of dispatch from their works, repair or, at its option, replace any goods, which are proven to have defects as a result of defective materials or workmanship.

The goods MUST be returned to Elta, carriage paid, for examination. An Elta Engineer or appointed person should attend to carry out any work, unless otherwise agreed. Elta will not accept accounts for workmanship by others.

Please see the Elta warranty booklet for full details on submitting a warranty claim.

Any modifications to the system or its installation, even the smallest modification, change or elimination of security components or pieces that influence the efficiency or loss of ventilation, will result in the CE Certification and Elta's warranty being cancelled.

Recycling

Elta use components, when possible, that are suitable for recycling at the end of the product's life, components can be segregated as stated below and processed in accordance with local regulations. Metallic items can be segregated and recycled; Electrical and Electronic equipment such as motors, cables and control devices can be segregated for WEEE recycling; Cardboard, wood, packaging, and plastic components can be widely recycled. Items not listed should be segregated in accordance with local authority zero waste hierarchy recommendations.

Tel **+44 (0)1725 511422**
Email **agriculture@eltauk.com**
eltauk.com/agriculture

Issue A. 06.2025